

NOTE: CAN GAIN 2" IN ROOM BELOW BY CUTTING BASE FLASHING TO 4 1/2 FROM 6 7/8"

REMOVE MASONRY WITH HAND TOOLS ONLY - NO POWER TOOLS OF ANY SORT - UNTIL NEW "C" SHAPES ARE INSTALLED & BOTTOM PLATES ARE WELDED IN PLACE & ALL GROUTING IS DONE

LEAD COATED COPPER FLASHING - EXTEND UP 2' ABOVE

BASE FLASHING ASSEMBLY: TWO LAYER 20 GA LEAD COATED COPPER - 12 ACROSS PEEK - HOT MOPPED IN PLACE; THEN ROOFING (2 LAYER MOD BITUMEN HOT MOPPED) THEN MOD. BIT. BASE FLASHING. INSTALL CAP FLASHING & POINT. (DO NOT SCRATCH OR CHEMICALLY ETCH CAP FLASHING)

1/4" GAP ALL SIDES OF FIELD OF PAVING STONES CENTER IN TUBE

1/4" Penetration weld  
weld or bolt Set in place post  
weld collar to square post  
weld in place post  
Base Nails  
Grout

LONGITUDINAL REBAR  
Point

2 1/2" MIN COVER OVER BEAM

W 8x40  
8 1/4" TALL -  
8 1/8" WIDE  
FLANGE 1/2"  
WEB 3/8"

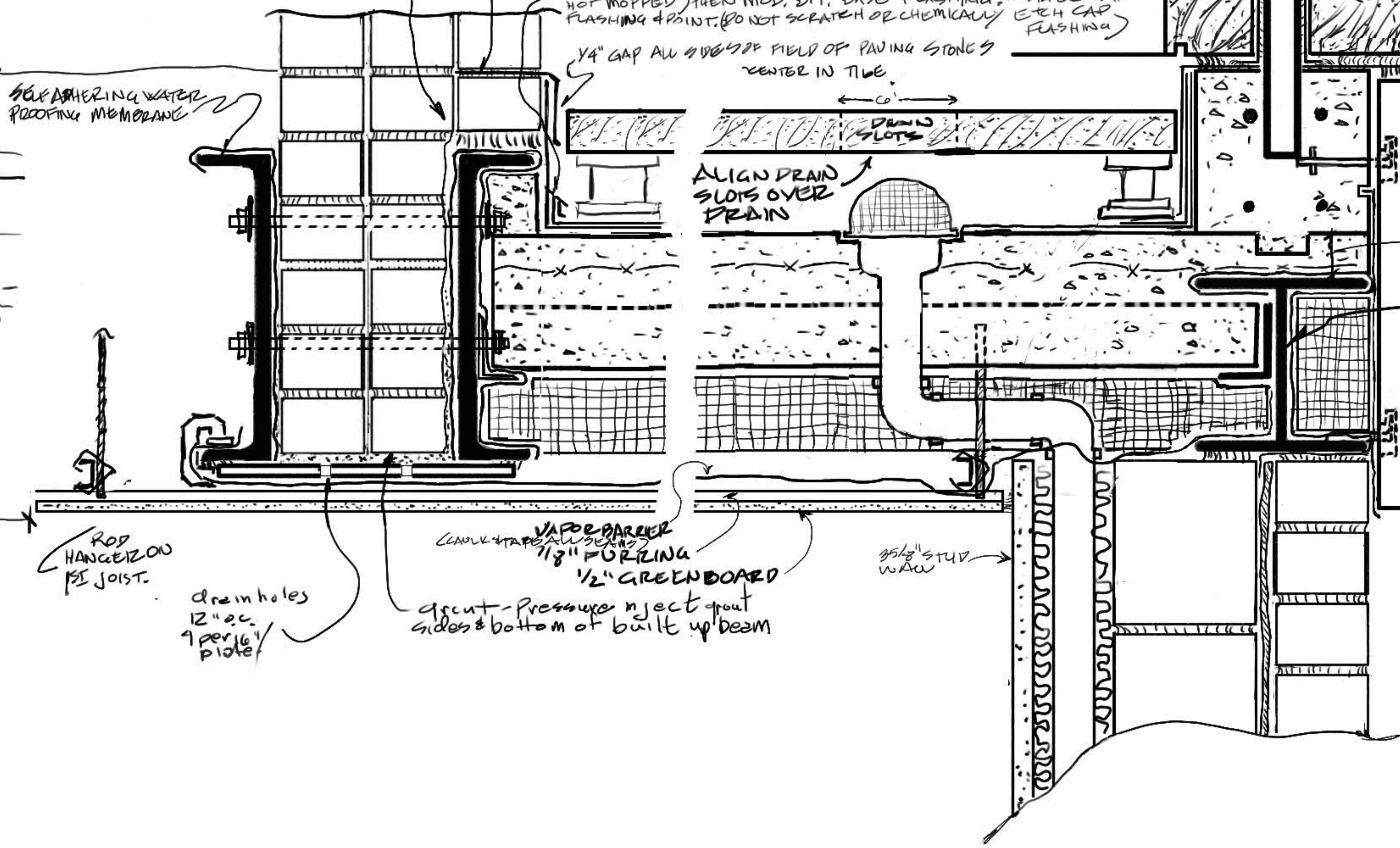
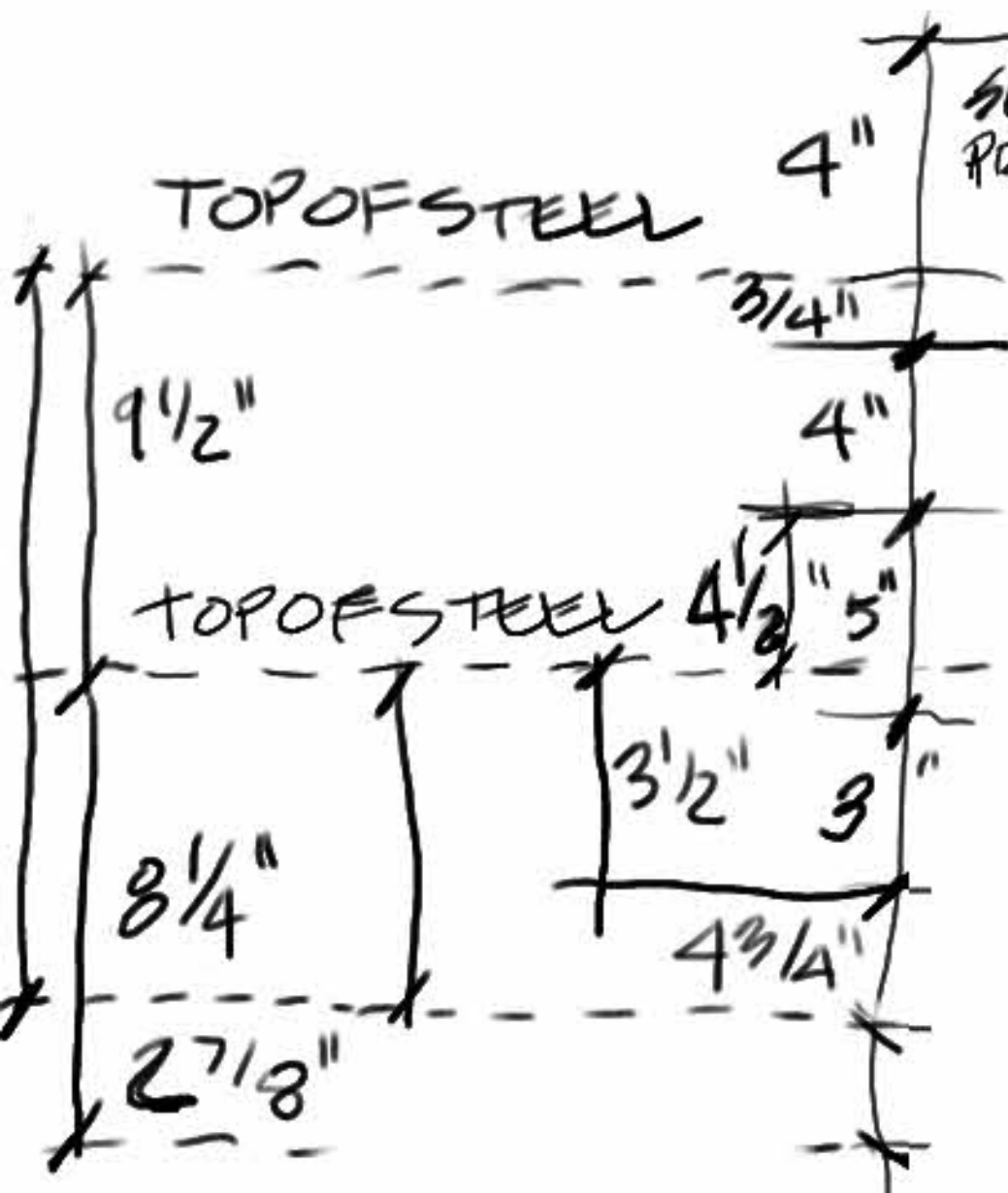

ROD HANGERS ON JOIST

drain holes 12" oc. 1 per 16" plate

VAPOR BARRIER  
1/2" GREENBOARD

grout - pressure inject grout sides & bottom of built up beam

95/10" STUD WALL