

Cut ditch
 3-4' deep
 Stack w/ 12"
 perforated
 drains, fill w/
 rock, filter
 fabric & drain
 board on house
 side
 continue under
 steps to pond

Perf drain
 buried divert
 runoff to
 below
 terrace well
 to water from
 beneath "wet"
 flowers like ms
 dry hilly pussy willow
 etc

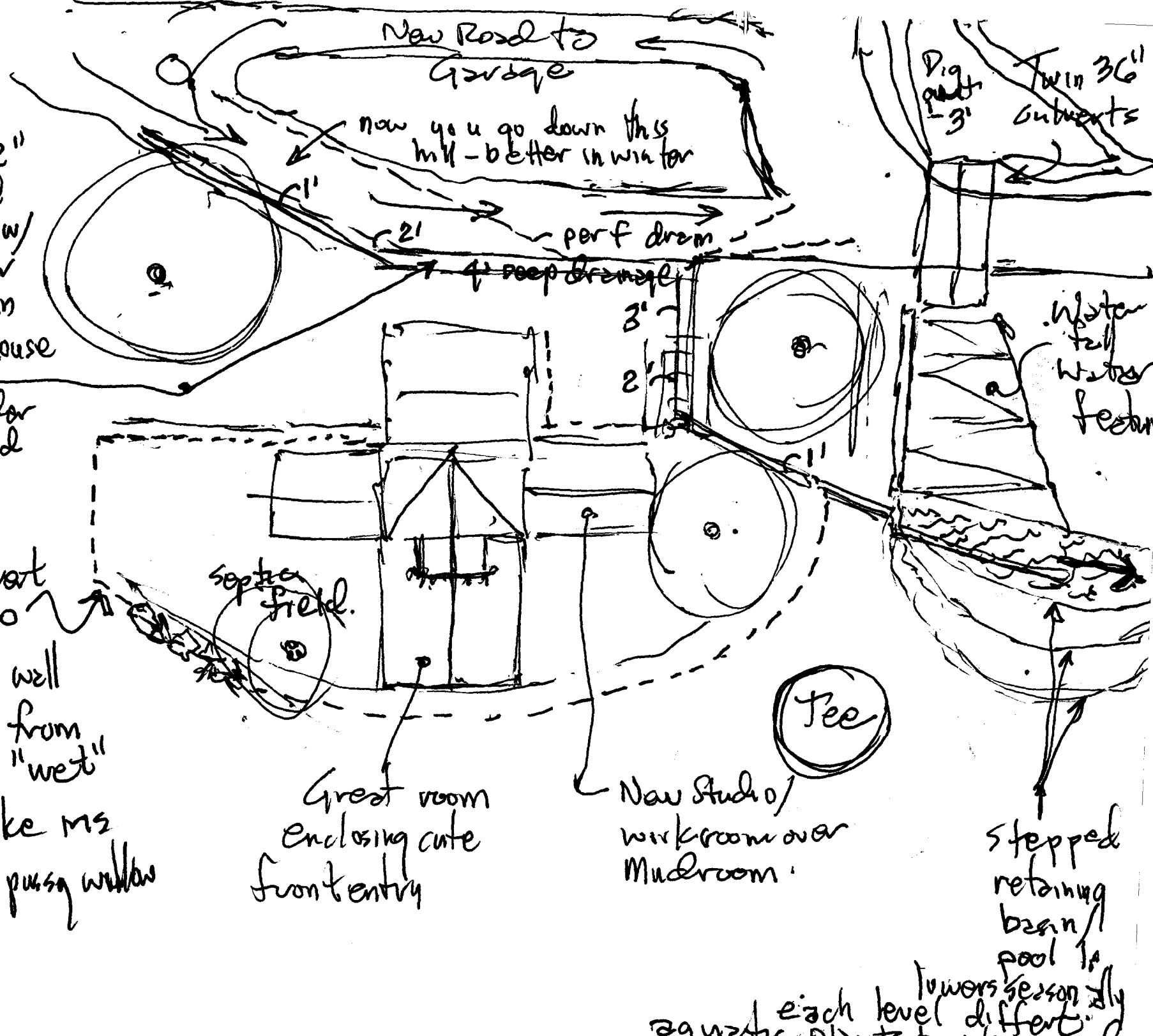

Great room
 Enclosing cute
 front entry

New Studio/
 workroom over
 Mudroom

Stepped
 retaining
 basin/
 pool

each level different
 aquatic plants
 flowers seasonally

1 yr wk.

1. Drainage ditch left & right of house to drain runoff away, Backhoe 2 men for fine grading 1-2 wk \$6,000 - \$10,000
2. Tie in beams old barn to replace metal rod ties, install stairs to attic \$15,000 - \$20,000 inc engineer, patching, probes
3. Dry wall infill over insulation - Might try gypsum board "bath" & finish coat plaster - this will adapt to irregular shapes best. DIY \$2,000
4. ^{in general} Balusters on stair down, close risers. \$2500
5. Kitchen \$10,000 ~~will stay~~ to finish whats there
6. Replace lower level ceiling & wall finish foam insul, repair cracked beam \$8000 mat. & GC + DIY for putting on GYP BR, doing demo work
7. Heating \$3000 pellet stove & flue \$3500 minimal dist heat from boiler - 2 FCU's / Pl. capable of 100% load on ~~sub~~ 400w/ motors off
8. T-11 siding on garage \$2000 mat ~~to~~ install DIY

- o Pest killer - Private road - costs & how / who decides what is done when, Is last trailer yr round occupancy? Meet that neighbor. There is tarp covered structure \pm 50' from turn in road at culvert. What is it, who is it?

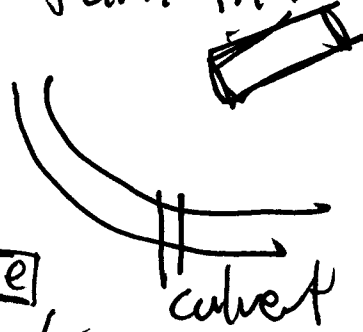

See if you can't get comment from others on drive on winter driving.

- o Esoteric plus - Putting green - Any business / professional enhancement from that - outside of improving game. Is use by other business to acquaintances a good possibility?

6

"On grade" great room

Could also consider 10' or
sun tempered buffer space
in winter.

Best for 2 or 3 seasons. Tough to
make toaster for long in winter
but possible.

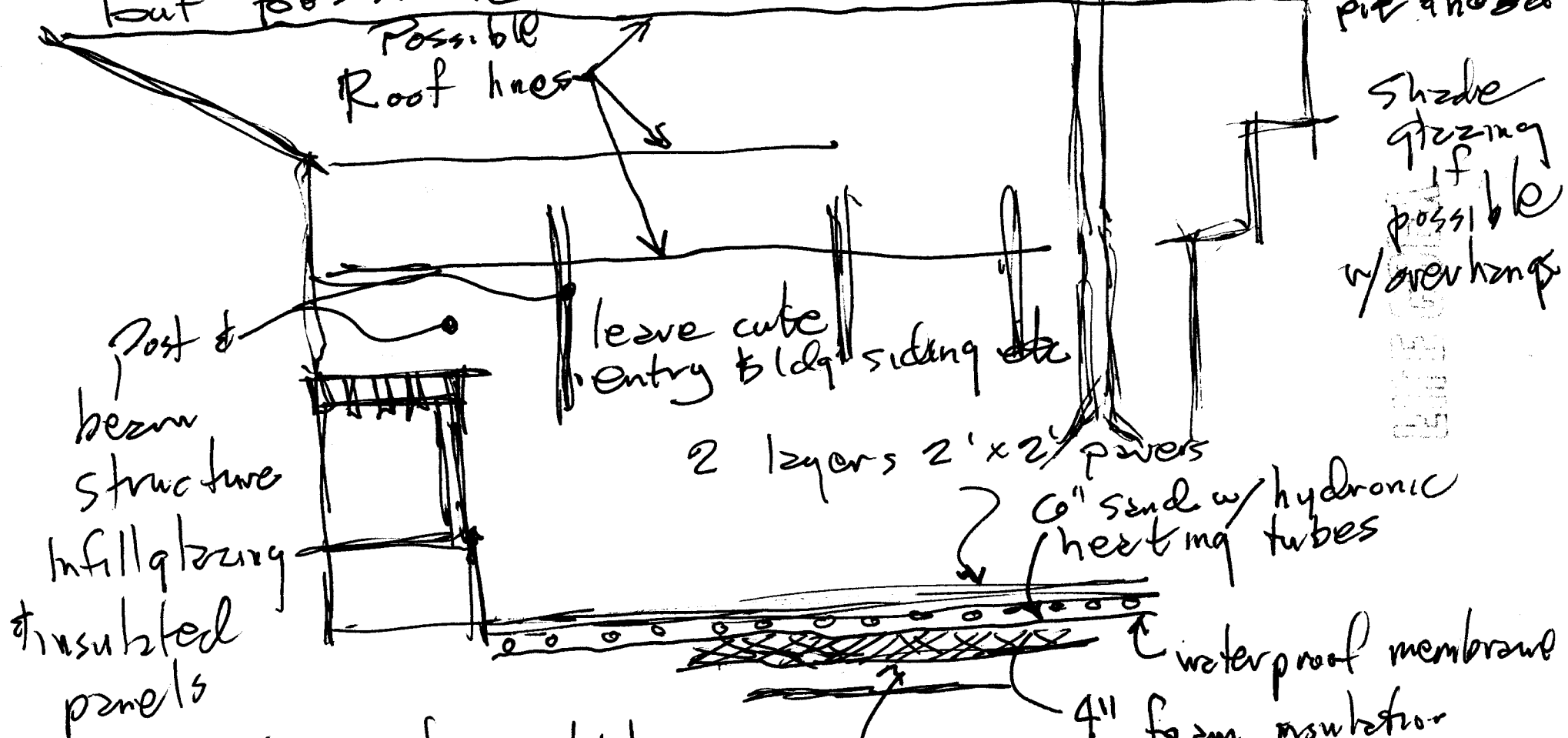

Combination of post & beam
structure & paver floor allows

removal of septic & access by equip if septic requires it
as unlikely as that is to be.